

ULTRALOCQ

Bolt Mission Installation Guide (V1.3)

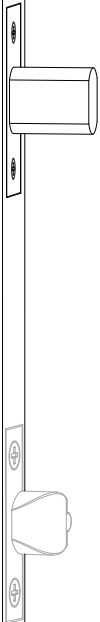
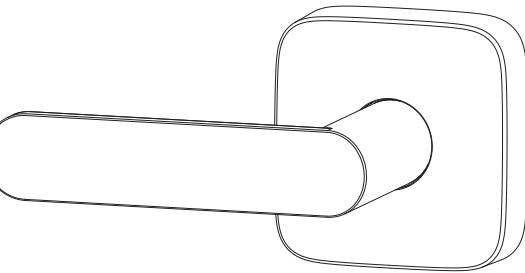

Important Notes

Test before final installation:

Always install and test the lock with the door open to avoid accidental lockouts. Read this manual carefully before installing and operating.

You may need:

Phillips Screwdriver.

Having a second person assist may be helpful.

Operating temperature:

Exterior: -4 °F(-20 °C) to 149 °F (65 °C)

Interior: 14 °F (-10 °C) to 131 °F (55 °C)

Do not insert batteries until the lock is fully installed.

Please use AA alkaline batteries or the ULTRALQ Bolt dedicated rechargeable lithium battery pack. We cannot guarantee performance or safety with other types of batteries.

Note: The Exterior Assembly of Bolt Mission is waterproof, but the Interior Assembly is not waterproof due to the exposed battery compartment.

Product Registration

For the best service and warranty coverage, please register your product at: www.ultralq.com/register

Terms & Policies

Before using any ULTRALQ products, please read all applicable terms, rules, policies, and usage provisions at: www.ultralq.com/privacy

By using your ULTRALQ device, you agree to the Privacy Policy.

Need Help?

For technical documents and more

Please visit support.ultralq.com

or call **1-844-439-8832**

Packing List

Interior Assembly



Exterior Assembly



Interior Assembly Mounting Plate



Dust Box



Strike Plate



Bolt

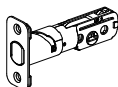

Screw A

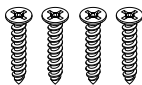

Screw B

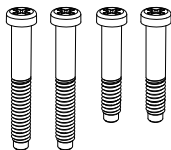

Screw C



Reset Needle



Door Sensor



Backup Keys



NFC Fob



Rechargeable Li-ion Battery



*USB Type-C charging port

Door Sensor Adhesive



User Guide



Installation Guide

Installation Video



Please scan the QR code to watch the installation video.

Or you can also view the website directly,
www.ultraloq.com/Bolt-Series

1. Preparing Door

Check the door's dimensions.

Step 1

Measure to confirm that the door is between $1\frac{3}{8}$ " ~ $2\frac{1}{4}$ " (35 mm-57 mm) thick.

Step 2

Measure to confirm that the diameter of the hole is $2\frac{1}{8}$ " (54 mm) or $1\frac{1}{2}$ " (38 mm)

Step 3

Measure to confirm that the backset is either $2\frac{3}{8}$ " or $2\frac{3}{4}$ " (60 mm or 70 mm).

Step 4

Measure to confirm that the diameter of the hole in the door edge is 1" (25 mm).

Step 5

Measure to confirm the depth of the hole in the frame is at least 1" (25 mm).

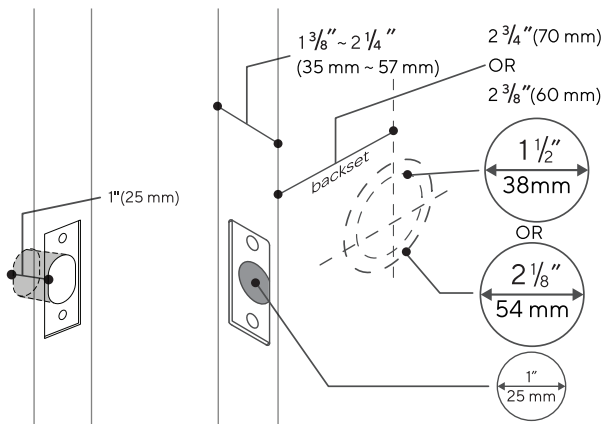

If you have a new door, please drill the holes according to Drill Template.

2. Installing Bolt and Strike

Step 1: Install the Bolt

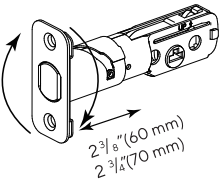

TO CONVERT FROM 2-3/8" (60mm) BACKSET TO 2-3/4" (70mm) BACKSET

1. Hold latch with "UP" facing forward and thumb pressing on the bolt.
2. Rotate the cylinder clockwise.
3. Twist the extension plate until it is all the way out.

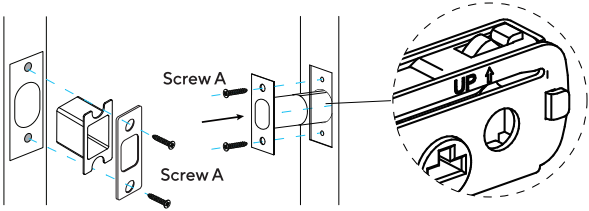

Step 2: Install the Strike

Align the strike plate with the door frame.

Secure it in place using the provided screws A(x4)

3. Installing the Exterior Assembly

Step 1: Position and Install

Ensure the bolt is fully retracted.

Make sure the cylinder tailpiece is horizontal, with the bump pointing upward.

Carefully install the Exterior Assembly onto the door.

Do not insert the mechanical key during installation.

Step 2: Route the Cable

Carefully thread the cable through the hole located below the bolt to the interior side of the door.

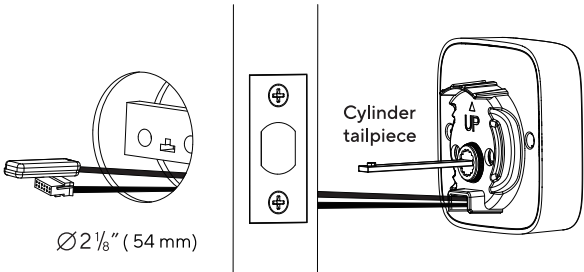

If your door has a 1½" (38 mm) bore hole, remove the spacer as shown. If not, don't remove it.

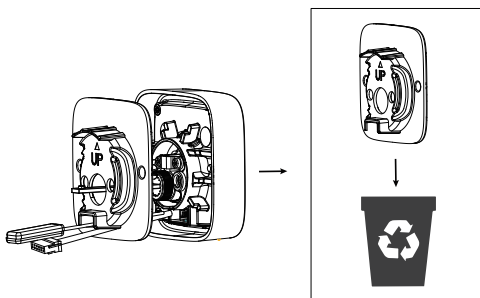

With No Spacer

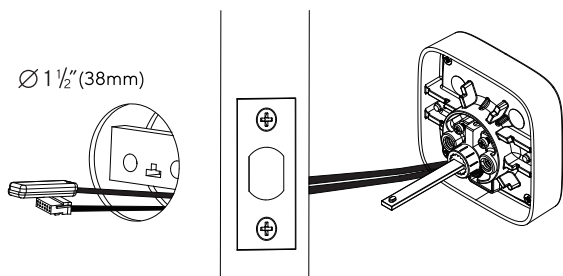

4. Installing the Interior Assembly Mounting Plate

Step 1: Route the cable

Route the cable through the hole in the Interior Assembly Mounting Plate.

Step 2: Secure the Mounting Plate

Secure the Interior Assembly Mounting Plate to the Exterior Assembly using Screw B(x2).

* Please select the appropriate screw B according to the actual door thickness.

Suggestion: It's recommended to first pass the UWB antenna through the mounting plate, and then pass the connection cable.

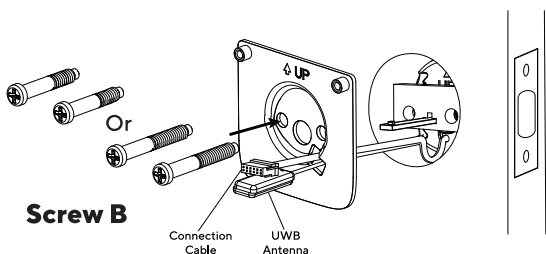

5. Installing the Interior Assembly

Warning: Do not install the batteries before installing the interior assembly, as this may prevent the keypad from powering on properly.

Step 1: Remove Battery Cover

Remove the battery cover from the Interior Assembly.

Step 2: Connect the cable to the Interior Assembly

Insert the cable connector into the socket on the Interior Assembly.

Make sure the concave and convex sides are aligned.

Press the connector firmly until it is fully seated.

Place the UWB antenna into the designated space.

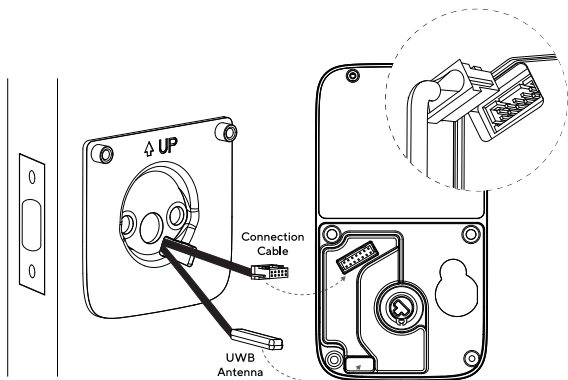

Step 3: Set to Unlocked Position

Rotate the knob to the vertical position to keep the lock unlocked during installation.

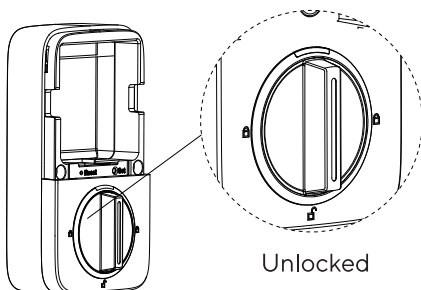

Step 4: Attach and Secure

Align the Interior Assembly with Mounting Plate.

Secure the Interior Assembly in place. The mounting screws are pre-installed in the holes

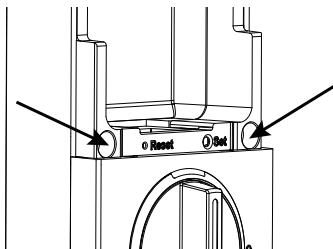

6. Installing the Batteries and Performing the Door Handing Process

This step helps your lock learn which way your door opens, so it can work properly.

Step 1: Set to unlocked position

Rotate the knob to the vertical position to keep the lock unlocked.

Step 2: Insert Batteries

The battery compartment is removable and supports replacement with a rechargeable battery pack.

Reattach the battery cover.

Note: Only the Program Code on the battery cover can unlock Bolt Series in Factory Default Mode.

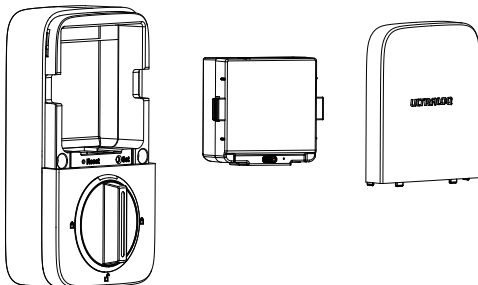

Note: Only the Program Code on the battery cover can unlock Bolt Series in Factory Default Mode.

Step 3: Perform Direction Calibration

Keep the bolt in the locked position, then reinstall the battery. The lock will automatically rotate and begin self-calibrating the door direction, which will complete in approximately 5 seconds.

During setup, your lock will also optimize its UWB positioning to ensure accurate proximity detection for future hands-free unlocks.

7. Installing the Door Sensor(Optional)

Door sensor lets you know whether the door is open or closed through the App. When Auto-Lock is enabled, your LOCK will automatically lock only when the door is fully closed.

Guidelines:

1. **Do not** mount the door sensor on the **keypad side** of the lock.
2. **Avoid** installing the sensor on **metal doors** that interfere with the internal magnet. (In such cases, the door sensor may stick to the metal door magnetically and malfunction.)
3. The sensor is **suitable for:**

Wooden doors.

Metal doors that **do not interfere** with the sensor's **magnetic field** (i.e., the sensor does not stick magnetically to the door).

Installing with Door Sensor Adhesive:

Remove the plastic film from both sides of the adhesive and use it to secure the door sensor.

This method requires no drilling, but it is not as sturdy as using screws.

Installing with Screw C

Drill two holes at the marked positions.

Press the door sensor against the wall and secure it using Screws C (x2).

Attach the door sensor cover by sliding it from top to bottom along the chute until it clicks into place.

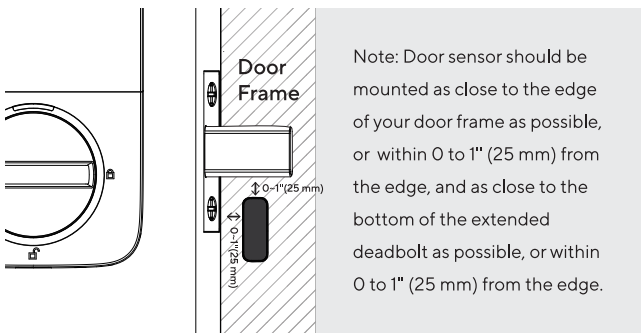
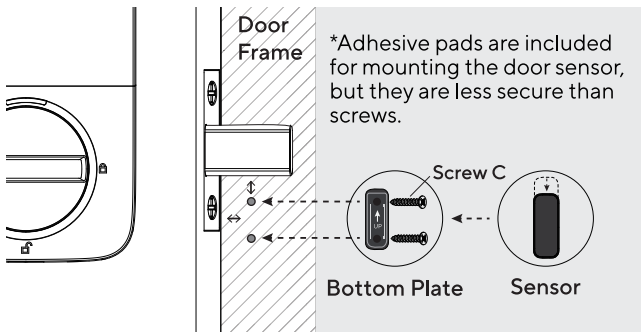

Note: Please refer to the guide in Xthings Home app for more information.

User Guide

User Guide Video

Please scan the QR code on the left to watch the user guide video. You can also visit the website directly at www.ultraqo.com/boltmission/guide.



For the configuration guide for integrations (Alexa, Google Assistant, Apple Home, and SmartThings), please scan the QR code on the right or visit support.ultraqo.com, then choose "Works with" to watch the user guide video.

1. Product Overview

1.1 Exterior Components

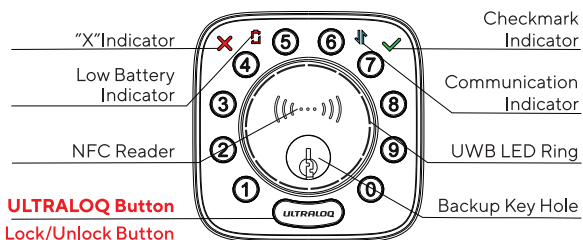

UWB LED Ring

Illuminates when Ultra-Wideband (UWB) proximity detection is active.

Communication Indicator

Flashes when the lock is communicating with your app or smart home system.

Checkmark Indicator

Lights up to confirm successful code entry or programming.

"X" Indicator

Lights up when an incorrect code is entered or a failed operation occurs.

Low Battery Indicator

Warns when the battery power is running low.

NFC Reader

Supports unlocking using a registered NFC Keyfob or NFC-enabled Android smartphone.

ULTRALOQ Button(Lock/Unlock Button)

Used to manually lock/unlock the door, illuminate the keypad, and confirm actions.

Backup Key Hole

Allows mechanical key access in case of battery failure or in other emergency situations.

ULTRALOQ Button has the following functions:

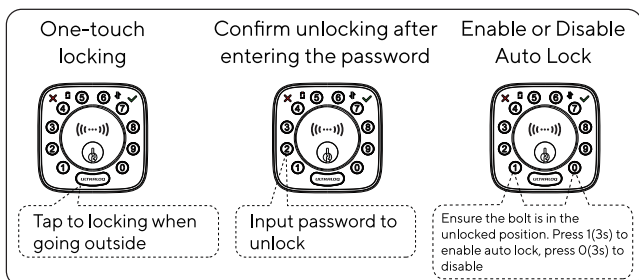

1.2 Interior Components

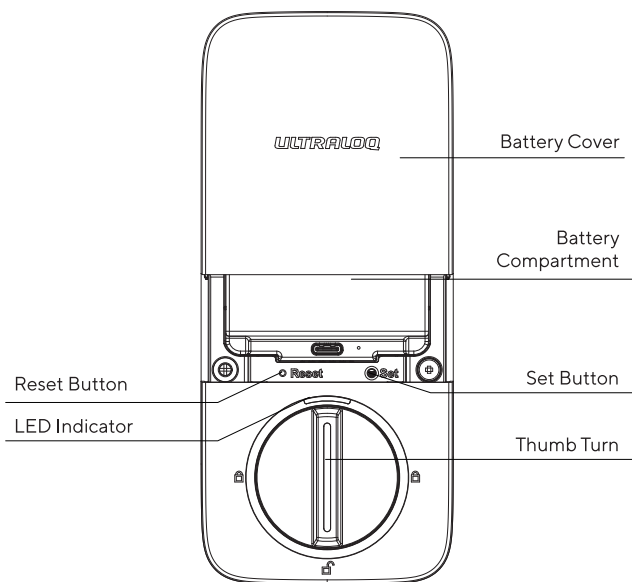

Reset Button

Used to reset the lock to Factory Default settings.

To reset, use a Reset Needle to press and hold the reset button (located under the battery cover) for about 10 seconds until you hear one long beep followed by two short beeps.

Note: If the lock was paired with an app, please first tap "Remove Device" in the app before resetting. For detailed reset instructions, refer to Page 12.

Set Button

Press and hold for 1 seconds to enable Matter pairing mode. Once enabled, the pairing mode will remain active for 10 minutes.

Press and hold for 10 seconds to reset the Matter-related configuration. Please use with caution.

Battery Cover

Protects the battery compartment and includes labels for the Program Code and the QR code for setup with other smart home platforms code.

Thumb Turn

Used to manually lock and unlock the door from inside.

LED Indicator

Turns green when the door is unlocked.

1.3 Low Battery Alarm

When the battery is low, the lock will beep three times, and the Low Battery Indicator will illuminate.

Note: Please replace the batteries promptly to avoid lock failure.

FAQ

1. How do I reset Bolt Mission?

Resetting will erase all data and restore factory default settings.

If registered in the Xthings Home app: Tap "Remove Device" in the app. The lock will automatically reset .

If the Xthings Home app reset is unsuccessful: Use a Reset Needle to press the Reset Button (under the battery cover) for 10 seconds, one long beep followed by two short beeps.

Reset Matter-related configuration: Press and hold **Set button** for 10 seconds to reset the Matter-related configuration.

Please use with caution.

2. What if I lost the smartphone paired with the lock?

Visit www.uhomelabs.com/account.

Or login to the Xthings Home app on another smartphone or tablet.

Change your Xthings Home Account password to secure your device.

3. How can I unlock the lock if the battery dies?

When the battery is low, the lock will emit three beeps and the low battery indicator will light up.

Replace the batteries as soon as possible.

If the battery is fully drained, use the backup key to unlock the door.

Please keep at least one backup key in secure location outside your home.

4. What's the difference between Owner, Admin, Normal User and Temporary User?

Role	Permissions
Owner	Original registrant. Full access to settings, logs, and user management.
Admin	Can unlock via app, code, or keycard. Can manage users and settings.
Normal User	Can unlock via app, code, or keycard. No admin privileges.
Temporary User	Limited access during a scheduled time window.

5. Can I use third-party accessories (e.g., bolt)?

It is recommended to use the original ULTRALOQ accessories for best performance and stability.

6. What is the log capacity?

The lock stores up to 1,000 activity logs. Once full, the newest entries will overwrite the oldest automatically.

7. What is the user capacity?

The lock supports up to 50 users. Each user can register 1 code and 1 Keyfob.

8. How can I extend battery life?

Please visit ultralock.com to contact us for an upgrade to a replaceable rechargeable lithium battery pack, which will significantly extend battery life.

9. Do I need an ULTRALOQ Bridge?

You don't need a Bridge to use the lock with Matter over Thread on supported smart home platforms.

However, if you want remote access and control through the Xthings Home app, you'll need a ULTRALOQ Bridge, which enables cloud connectivity and voice assistant integration.

10. What network does the lock support?

The lock natively supports Thread and Matter over Thread connectivity for local, secure communication. It does not support direct Wi-Fi connection.

For remote access and cloud-based features, you can use the ULTRALOQ Bridge, which connects over 2.4 GHz Wi-Fi (5 GHz Wi-Fi is not supported).

ULTRALOQ

A Brand of Xthings

© 2026 Xthings Inc. All rights reserved.

ULTRALOQ and ULTRALOQ logo are trademarks of Xthings Inc. or its affiliates registered in the U.S. and other countries and regions. All other trademarks are the property of their respective owners.

Xthings Inc. 47703 Fremont Boulevard, Fremont, CA 94538

Engineered by Xthings, assembled in China.