

# Ulticom Dot

## User Guide (V1.2)

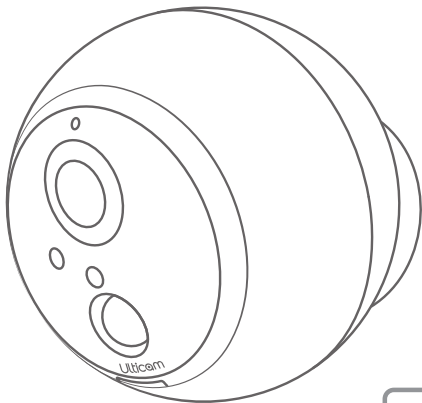

# Specifications

<b>Power:</b>	4x AA Lithium battery
<b>Temp:</b>	-4°F to 122°F / -20°C to 50°C
<b>Humidity:</b>	10% to 90% (non-condensation)
<b>Connection:</b>	802.11 b/g/n 2.4 GHz WiFi, Bluetooth
<b>Storage:</b>	Internal EMMC

Scan QR code to view the User Guide or visit:  
***[www.u-tec.com/ulticam/dot/guide](http://www.u-tec.com/ulticam/dot/guide)***



## Need Help?

For technical documents and more support

Please visit [www.u-tec.com/support](http://www.u-tec.com/support)

or call 1-844-439-8832

Privacy Statement: Before using any U-tec product, please visit the official website: [www.u-tec.com/company/privacy](http://www.u-tec.com/company/privacy) to understand the terms, rules, policies, and regulations. The use of U-tec products implies your acceptance of the U-tec Privacy Policy.

# What's in the box?



Ulticam Dot



Magnetic Base



AA Lithium battery



Screw



Expansion Tube



Double-sided  
Tape



User Guide



Warning  
sticker

# Tools for Set Up



Phillips screwdriver

OR

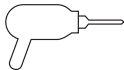

Electric drill



**Note:** The magnetic force of the base is very strong. Please be careful with your fingers and remove it from the box when using.

# Device Interface

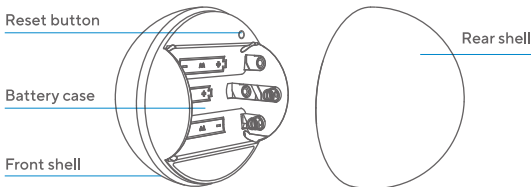
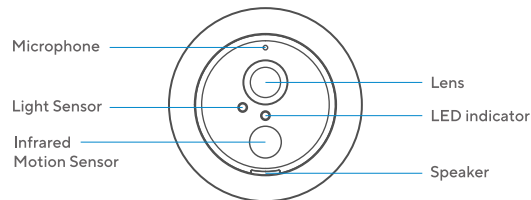

**Note:** When separating the front shell and the rear shell, a bit more force may be required.

# Installation and Setup

1. Pinch both the front and rear shells simultaneously with both hands, then pull outward forcefully to separate the front and rear shells.

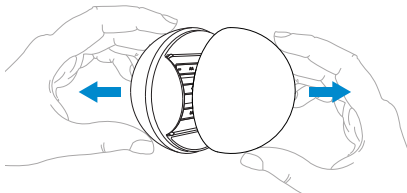

2. Insert the 4\*AA batteries into the battery case in the correct orientation. Lithium batteries are recommended for longer battery life.

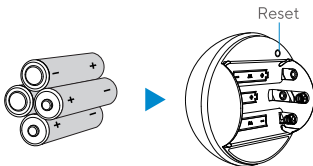

# Ulticam



© 2024 U-tec Group Inc. U-tec and Ulticam brands and products are trademarked and protected under law in the United States. Unauthorized use is prohibited. Ulticam is sub-brand of U-tec Group Inc.

3. Use a pin to press and hold the Reset button for more than 5 seconds. The camera will emit a voice prompt and the indicator light will flash blue to indicate that the camera has successfully entered pairing mode.

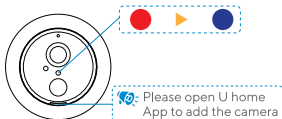

4. Add and configure the camera in the "U home" APP.

5. Reassemble the front and rear shells and press them together to complete the installation.

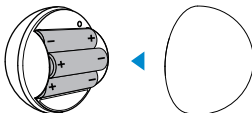

## LED Indicator

Red Blink:	Network failure or low battery
Green Standby:	Functioning normally
Green Blink:	Network connecting
Blue Blink:	The Camera is in pairing mode

## Reset button

Pairing mode: Hold for more than 5 seconds to enter the camera's pairing mode.

# Mounting Instructions

Ulticam Dot can be installed at any indoor or outdoor spot. Typical spot includes desk, wall, and ceiling.

## Mount Ulticam Dot to Desktop

1. Place the magnetic base at your preferred spot.
2. Mount the camera onto the magnetic base and adjust the viewing angle.



## Mount Ulticam Dot on the wall or ceiling

1. Make a hole in the wall with an electric drill and then insert the expansion tube into the hole.
2. Use screws to fasten the magnetic base to the expansion tube.

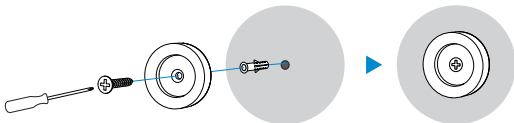



## Mount Ulticam Dot onto a Wooden Board or Glass

1. Stick the circular double-sided adhesive onto the magnetic base, then adhere the magnetic base to the desired installation location.



2. Rotate the camera to change the viewing angle.

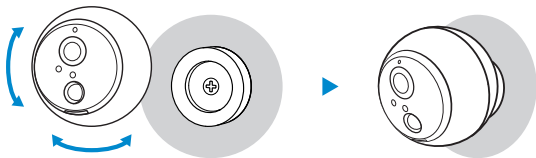

# Easy Setup

## 1. Get U home App Ready

### 1.1 Download App

Scan following QR code to download the app, or search "U home by U-tec" in App Store (iOS) or "U home" in Play Store (Android).



### 1.2 Create Account and Login

## 2. Add New Camera

Tab on the "+" icon in the App's homepage to add a new camera and follow the App's instructions to complete the setup process.

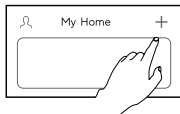

Add and Play

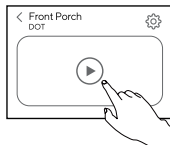

# FCC Warning:

This equipment has been tested and found to comply with the limits for a Class B digital device, pursuant to part 15 of the FCC Rules. These limits are designed to provide reasonable protection against harmful interference in a residential installation. This equipment generates, uses and can radiate radio frequency energy and, if not installed and used in accordance with the instructions, may cause harmful interference to radio communications. However, there is no guarantee that interference will not occur in a particular installation. If this equipment does cause harmful interference to radio or television reception, which can be determined by turning the equipment off and on, the user is encouraged to try to correct the interference by one or more of the following measures:

- Reorient or relocate the receiving antenna.
- Increase the separation between the equipment and receiver.
- Connect the equipment into an outlet on a circuit different from that to which the receiver is connected.
- Consult the dealer or an experienced radio/TV technician for help.

## **Caution:**

Any changes or modifications to this device not explicitly approved by manufacturer could void your authority to operate this equipment.

This device complies with part 15 of the FCC Rules. Operation is subject to the following two conditions:

(1) This device may not cause harmful interference, and (2) this device must accept any interference received, including interference that may cause undesired operation.

The device has been evaluated to meet general RF exposure requirement.

This equipment complies with FCC radiation exposure limits set forth for an uncontrolled environment.

This equipment should be installed and operated with minimum distance 20cm between the radiator & your body.

### **Battery Safety (Only for the Battery Product)**

Keep the battery away from any fire, explosion, or other potential hazards. Never use the device in a setting that is extremely hot or cold, or expose it to intense sunlight or a very damp atmosphere. It is advised to charge the device in a well-ventilated space with a typical room temperature.

This symbol refers that the product must not be discarded as household waste, and should be delivered to an appropriate collection bucket for recycling. Proper disposal and recycling help to protect natural resources, human health and the environment. For more information on disposal and recycling of this product, contact your local municipality, disposal service, or the shop where you bought this product.



**FCC ID : 2AJZ2-ULTICAM-D01**